

# USE MANUAL

## Car Stereo

### for Hyundai Sonata

### 2011-2014

Central Control Disassembly  
and Operation

Post-installation rendering



#### Wiring diagram



#### B-cables XC-741

Connect to the original car harness plug: power/speaker/SWC

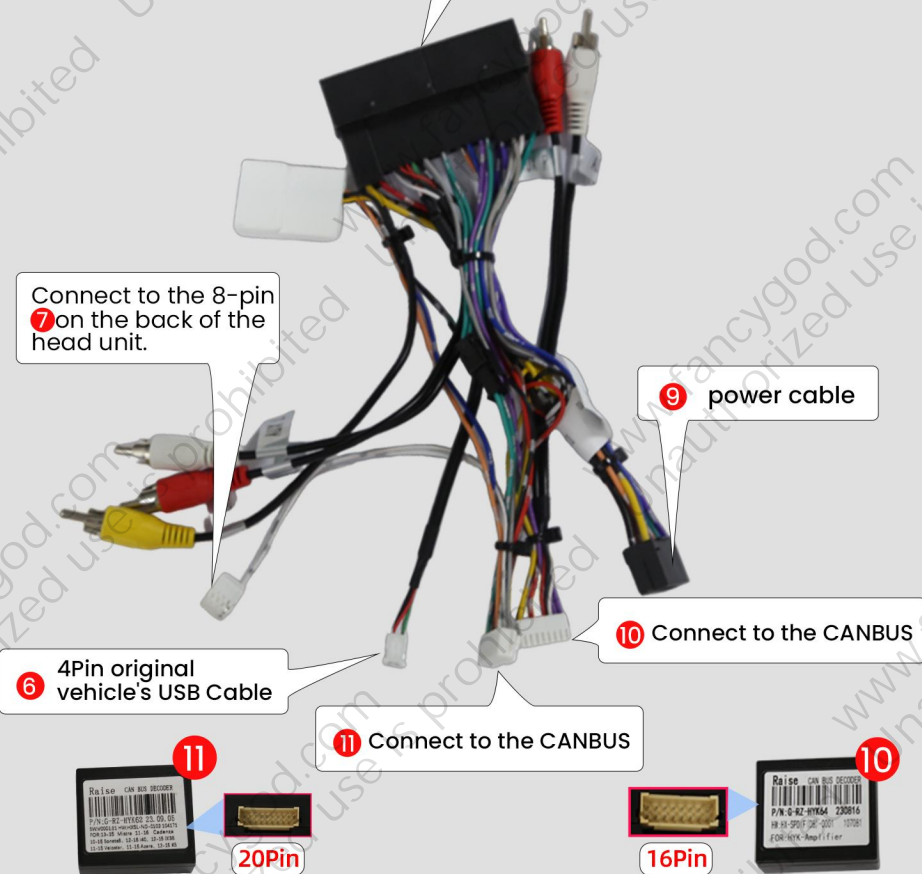

#### A-cables XC-1120

Connect to the original car harness plug: OEM Camera/Amplifier/Power



#### Power Line Definition Chart

Front Left (+)	<input type="checkbox"/>	<input type="checkbox"/>	Rear Right (+)
Front Left (-)	<input type="checkbox"/>	<input type="checkbox"/>	Rear Right (-)
Front Right (+)	<input type="checkbox"/>	<input type="checkbox"/>	Rear Left(+)
Front Right (-)	<input type="checkbox"/>	<input type="checkbox"/>	Rear Left(-)
Steering Wheel Key(+)	<input type="checkbox"/>	<input type="checkbox"/>	Power Antenna(+)
Rear Camera(+)	<input type="checkbox"/>	<input type="checkbox"/>	Steering Wheel Key 2 (+)
Accessory/Ignition(+)	<input checked="" type="checkbox"/>	<input type="checkbox"/>	Dimmer/Illumination (+)
Chassis Ground (-)	<input checked="" type="checkbox"/>	<input checked="" type="checkbox"/>	Constant power supply

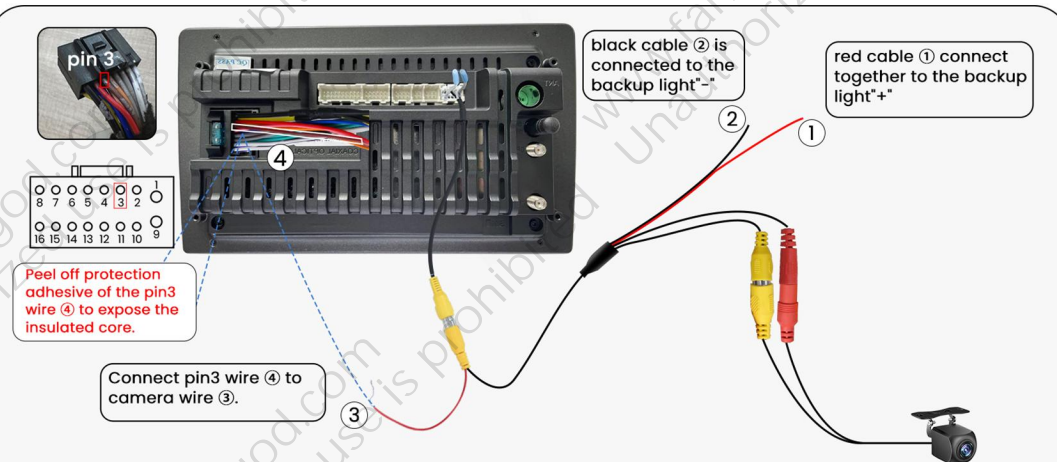

Wires color may be different due to various batches, but pin locations will be the same. You can search Youtube video ID "VWCKICYwF5s" on Youtube to find our supplied camera connection video tutorial



**Note: please select the correct wiring harness (A-cables or B-cables) according to the shape and pin configuration of the factory car's plug.**

If you are using **A-cables**, please follow the steps shown in picture 1: Enter Settings → Factory (enter password 3368), then select Car Model and choose “NULL—OTHER—No protocol—Null.”

If your car has steering wheel control buttons, to ensure they work properly, open the SWC app on the radio and follow the app's instructions to manually learn the steering wheel control keys (as shown in picture 2).

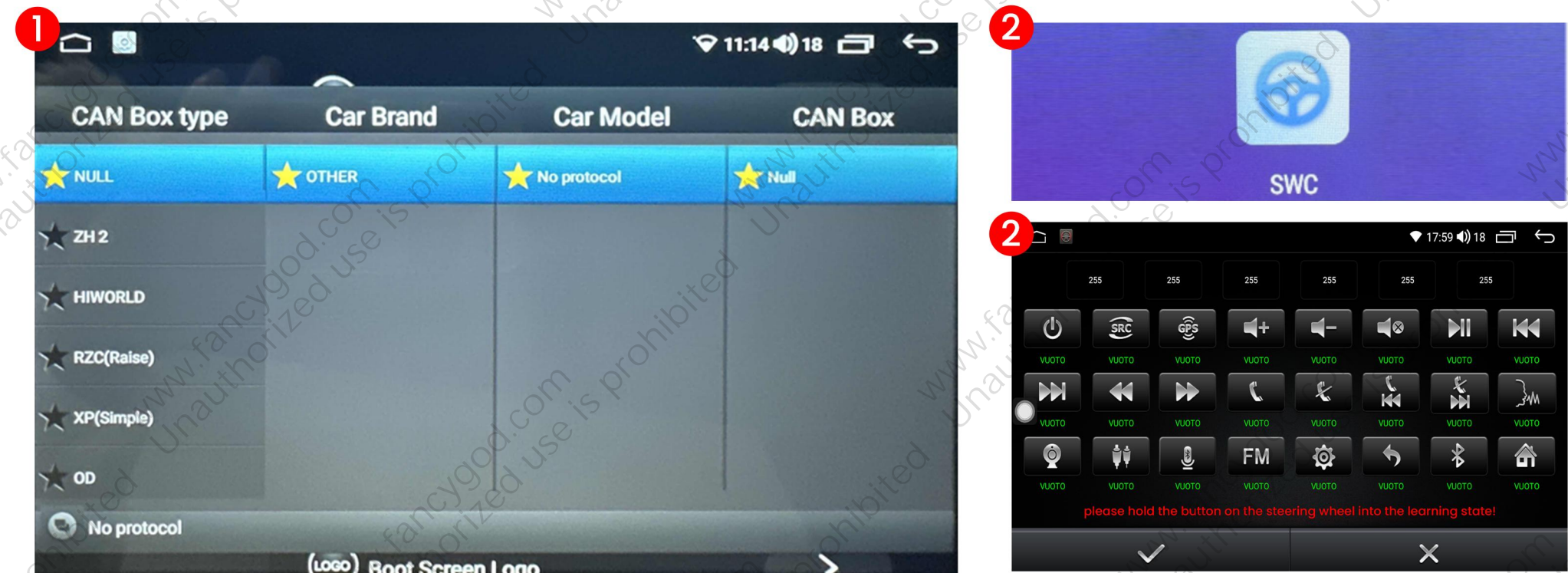

If you are using **B-cables**, to prevent issues with steering wheel controls, air conditioning, or volume not functioning properly, please follow the steps shown in Image 3: Press Settings → Factory (input password: 3368) → Car Model, and select “RZC(Raise) — Hyundai/KIA — Sonata8 — 2010-2015.”

CAN Box type	Car Brand	Car Model	CAN Box
★ RZC(Raise)	★ Hyundai/KIA	★ Sonata8	★ 2010-2015
★ XP(Simple)	★ Volkswagen	★ KX7	
★ OD	★ GM/Chevrolet	★ KX CORSS	
★ LSdT	★ Toyota	★ Rohens Coupe	
★ BNR	★ Nissan	★ Sorento	
★ DaoJun	★ Ford	★ Sportage	

For more guidance/video tutorial, please copy this link or scan the QR code to enter into our official website:

<http://www.fancygod.com>

Instructions

