

# USE MANUAL

## Car Stereo

### for Honda Odyssey

#### 2005-2010

Central Control Disassembly  
and Operation

Post-installation rendering



### Wiring diagram

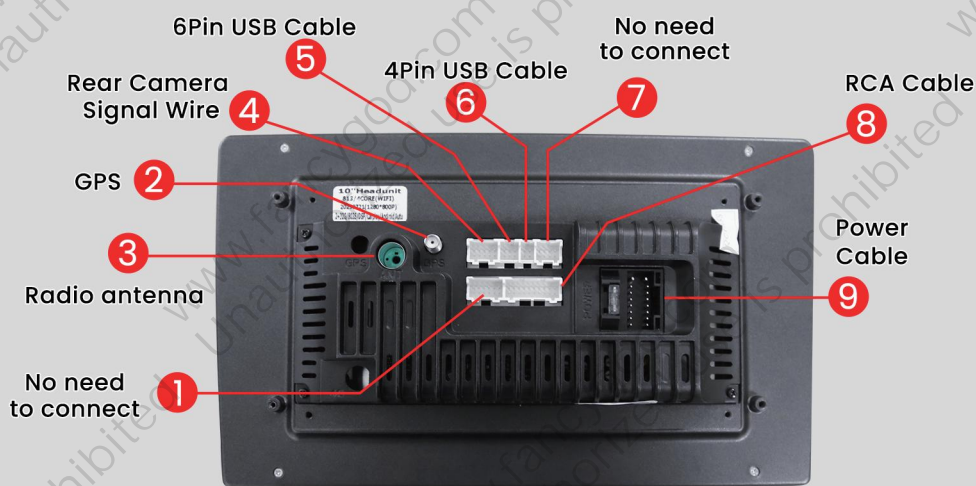

MIND the connector clip direction  
(clips end facing down).

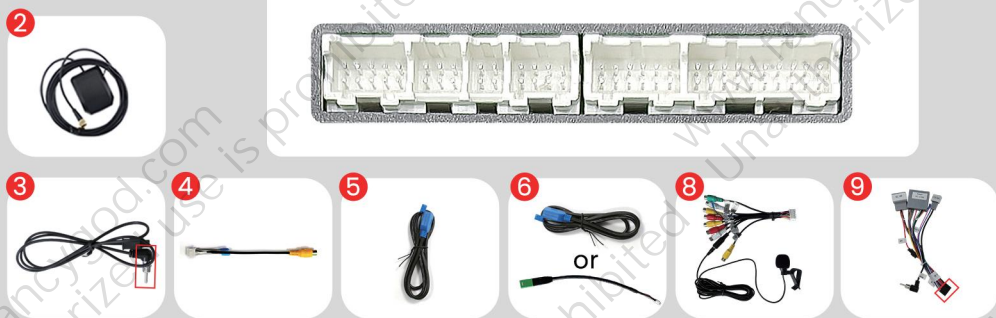

### A-cables XC-485

Connect to the original car harness plug: power/speaker/SWC

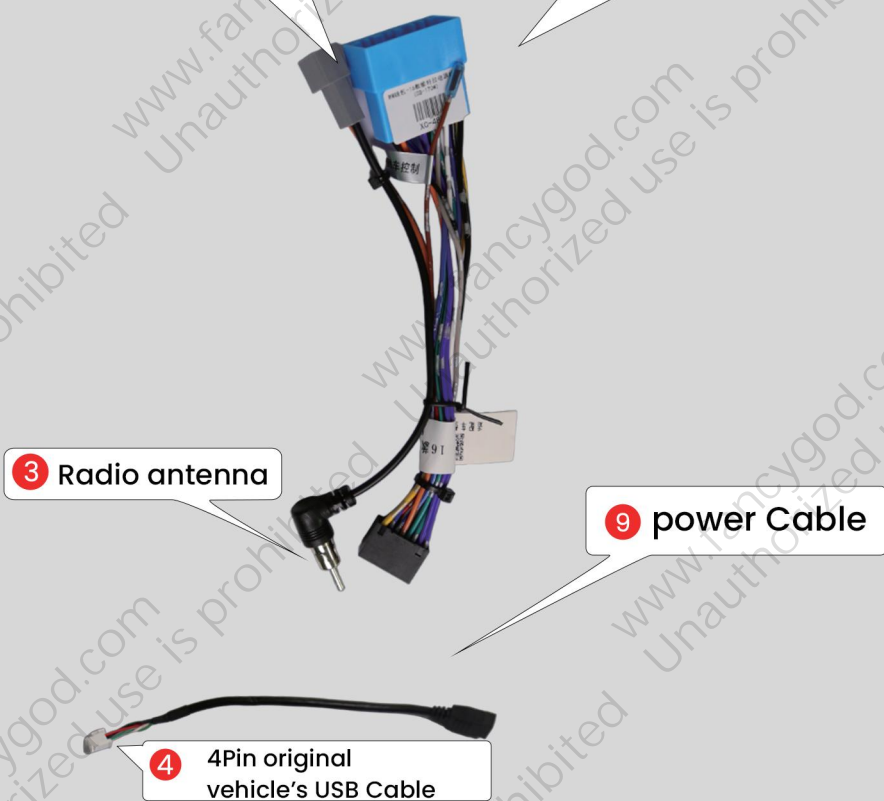

### B-cables XC-1396

Connect the to original car harness plug: power/speaker/SWC



### Power Line Definition Chart

Front Left (+)	<input type="checkbox"/>	<input type="checkbox"/>	Rear Right (+)
Front Left (-)	<input type="checkbox"/>	<input type="checkbox"/>	Rear Right (-)
Front Right (+)	<input type="checkbox"/>	<input type="checkbox"/>	Rear Left(+)
Front Right (-)	<input type="checkbox"/>	<input type="checkbox"/>	Rear Left(-)
Steering Wheel Key(+)	<input type="checkbox"/>	<input type="checkbox"/>	Power Antenna(+)
Rear Camera(+)	<input type="checkbox"/>	<input type="checkbox"/>	Steering Wheel Key 2 (+)
Accessory/Ignition(+)	<input checked="" type="checkbox"/>	<input type="checkbox"/>	Dimmer/Illumination (+)
Chassis Ground (-)	<input checked="" type="checkbox"/>	<input checked="" type="checkbox"/>	Constant power supply

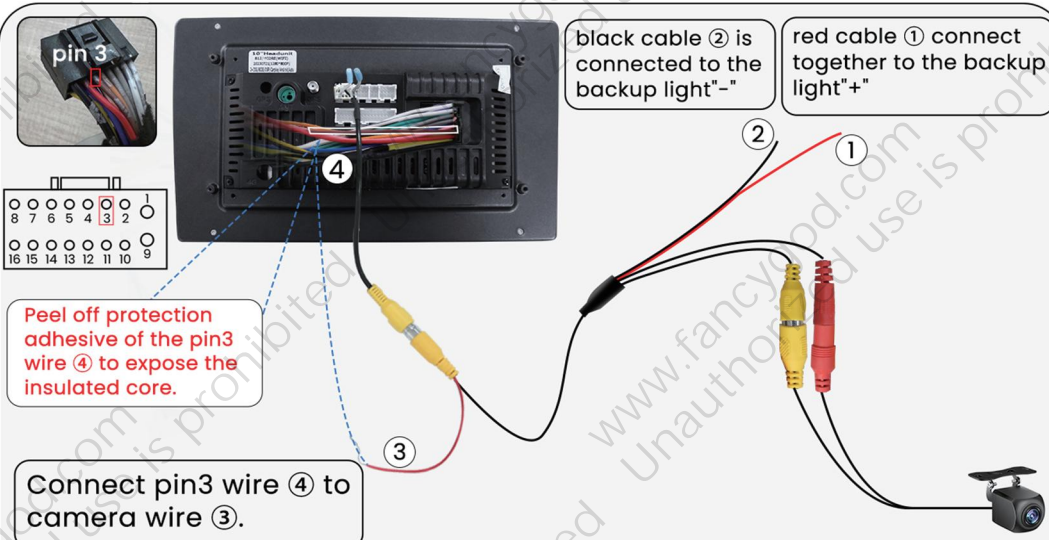

Wires color may be different due to various batches, but pin locations will be the same. You can search Youtube video ID "VWck1CYWF5s" on Youtube to find our supplied camera connection video tutorial

For more guidance/video tutorial, please copy this link or scan the QR code to enter into our official website:

<http://www.fancygod.com>

Instructions





**Note: please select the correct wiring harness (A-cables or B-cables) according to the shape and pin configuration of the factory car's plug.**

If there's no sound from the radio after connecting the **B-cables**, please connect these two plugs as shown in the picture below.

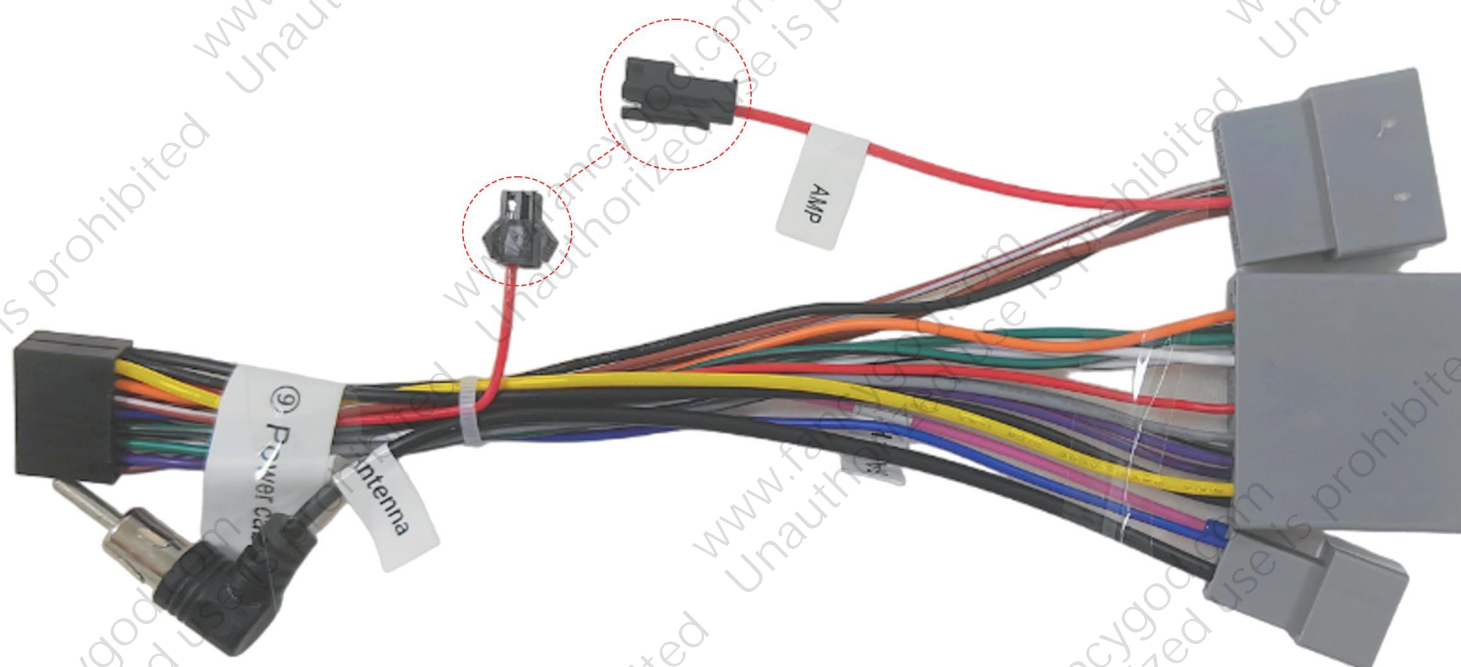

Please be sure to follow the steps shown in pic **1**; Enter Settings → Factory (input password 3368) → Car Model to choose “NULL— OTHER — No protocol — Null.”

If your car has steering wheel control buttons, to prevent the steering wheel controls not working properly, please open the SWC app on the radio and refer to the app's instruction to manual learn the steering wheel control keys accordingly (as shown in pic **2**).

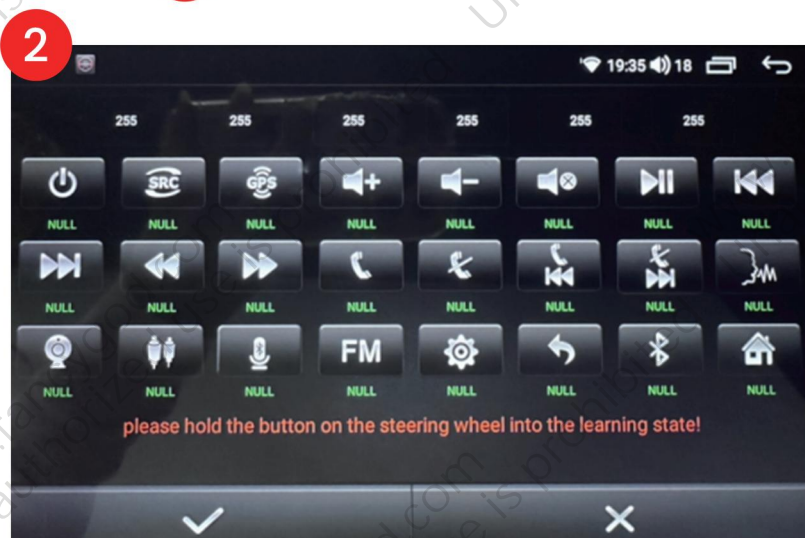

## FAQ

### Q: How to use wireless Apple CarPlay?

1. Turn on Bluetooth app on the radio and connect to your phone's bluetooth (password: 0000).
2. Open the Carlink 2.0 App on the car radio to activate Carplay. (Scan the QR code on the right to view the video tutorial)



### Q: How to use wireless Android auto?

1. Turn on Bluetooth app on the radio and connect to your phone's bluetooth (password: 0000).
2. Download the Android Auto APP at your phone's Play store first (Confirm the phone can support Android Auto).
3. Open the Carlink 2.0 App on the car radio to activate Android Auto. (Scan the QR code on the right to view the video tutorial)

