

Post-installation rendering



8-pin of the

9 Power

3 Radio

6 4Pin original vehicle's USB Cable

Front Left (+)			Rear Right (+)
Front Left (-)			Rear Right (-)
Front Right (+)			Rear Left(+)
Front Right			Rear Left(-)
Steering Wheel Key(+)			Power Antenna(+)
Rear Camera(+)			Steering Wheel Key 2 (+)
Accessory/Ignition(+)			Dimmer/Illumination (+)
Chassis Ground (-)			Constant power supply

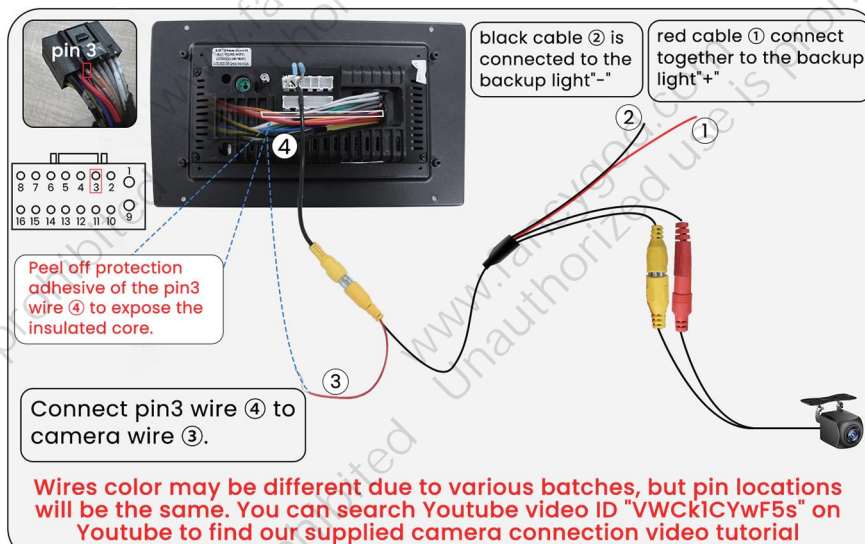

Note:Since the D-type cable (XC-933) contains multiple plugs, the required cable varies depending on the factory radio.

To avoid issues such as the radio not powering on due to incorrect cable connections; or the volume not being adjustable, steering wheel controls not functioning, and sound abnormalities due to setting errors, be sure to carefully follow the installation tutorial steps and the corresponding setup steps.

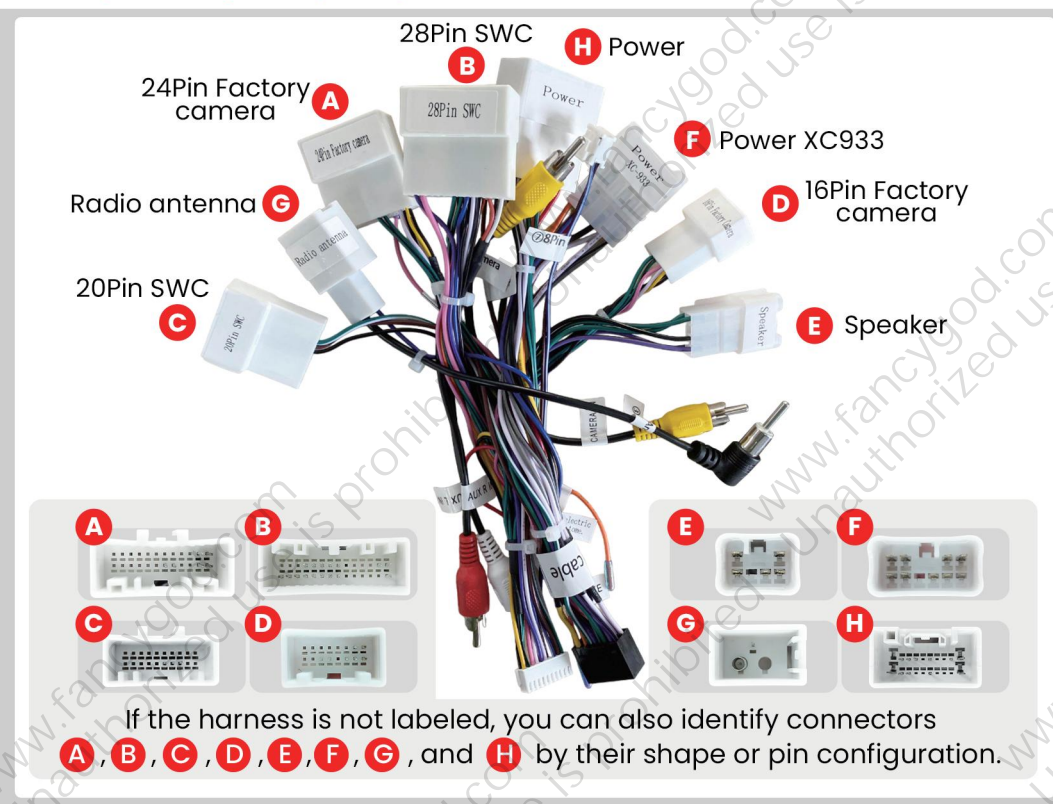

If your factory radio matches Image ①, please connect F, E, B and G harness from the D-cable (XC-933) (The remaining harness do not need to be connected) to the plugs from factory radio, and follow the steps shown in Image ②

Please press "Settings" → "Factory Settings" (enter password 3368) → Car Model," and set it to "NULL-OTHER -No Protocol-Null."

If your car has steering wheel control buttons, according to Image ③, please open the SWC app on the radio and refer to the app's instructions to manually learn the steering wheel control keys.



If your factory radio matches Image ④, please connect F, E, A, B and G harness from the D-cable(XC-933) (The remaining harness do not need to be connected) to the plugs from factory radio, and follow the steps shown in image ⑤

Please press "settings" → "Factory Settings" (enter password 3368) → "Car Model," and set it to "XP (simple) - Toyota - Camry - XP."

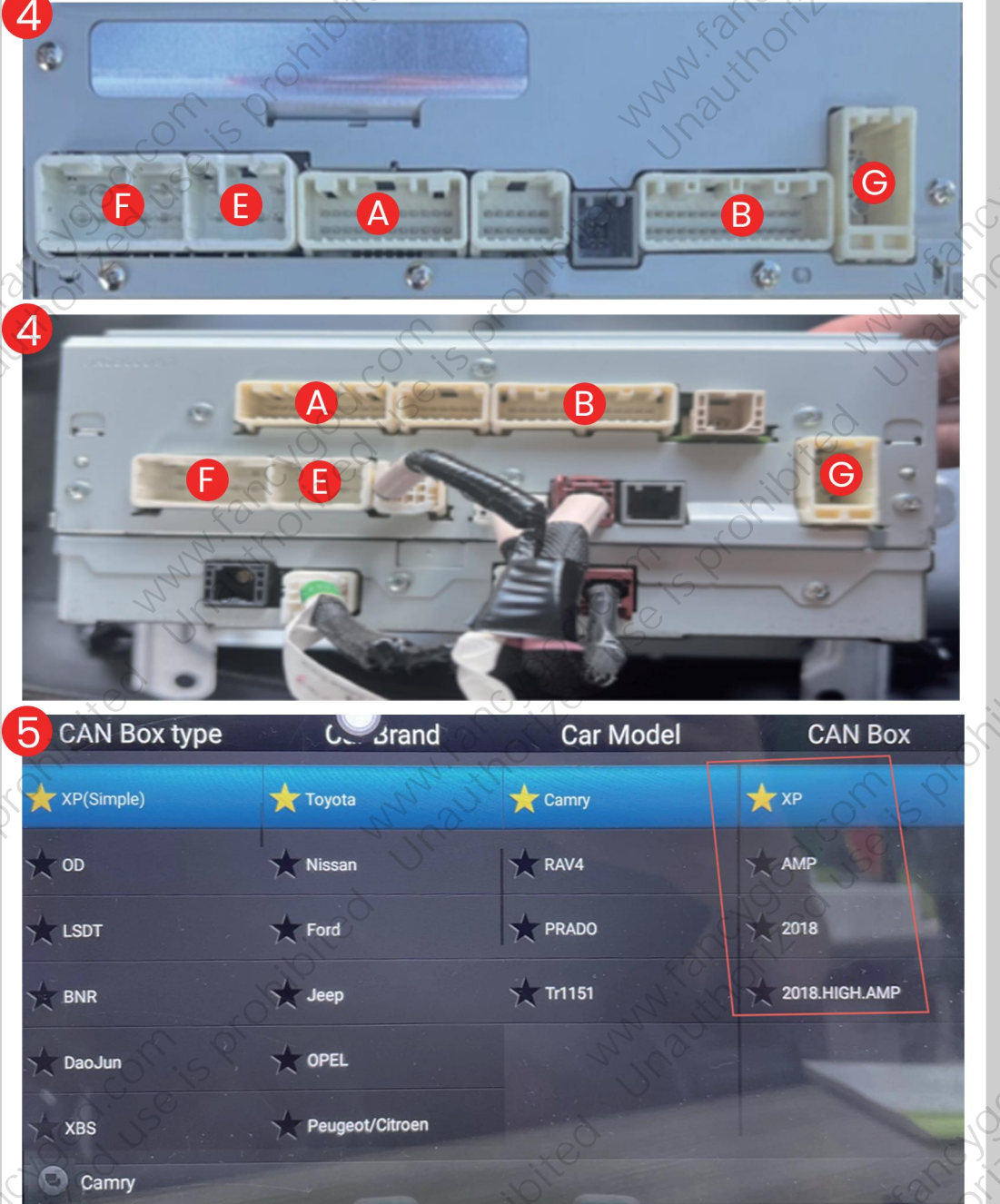

If your factory radio matches Image ⑥ (with JBL sound system), please connect H, A, B and G harness from the D-cable(XC-933) (The remaining harness do not need to be connected) to the plugs from factory radio, and follow the steps shown in Image ⑦

Please press "Settings" → "Factory Settings" (input password 3368) → Car Model," and set it to "XP(simple) - Toyota - Camry - AMP."

If sound abnormalities persist after selecting AMP, switch the CAN Box option to "2018.HIGH.AMP."

