

USE MANUAL

for Hyundai Elantra
2014-2016

Central Control Disassembly
and Operation

Post-installation rendering



Wiring diagram

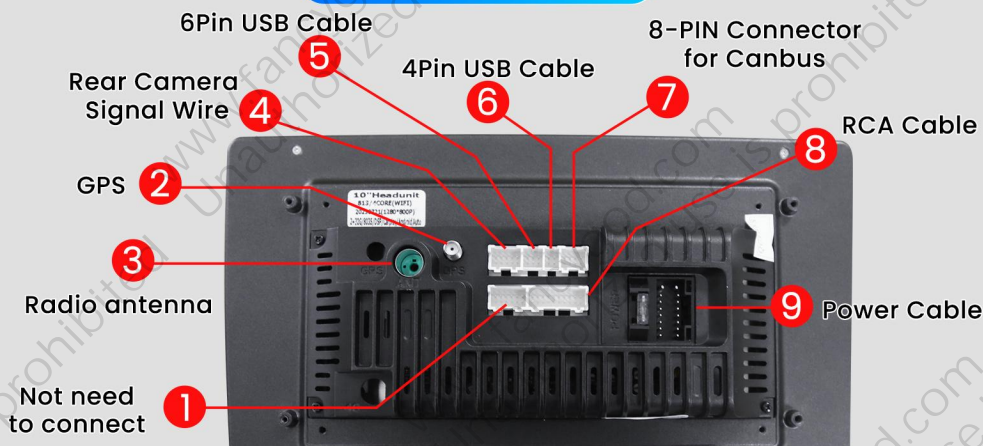

MIND the connector clip direction
(clips end facing down).



B-cables XC-1397

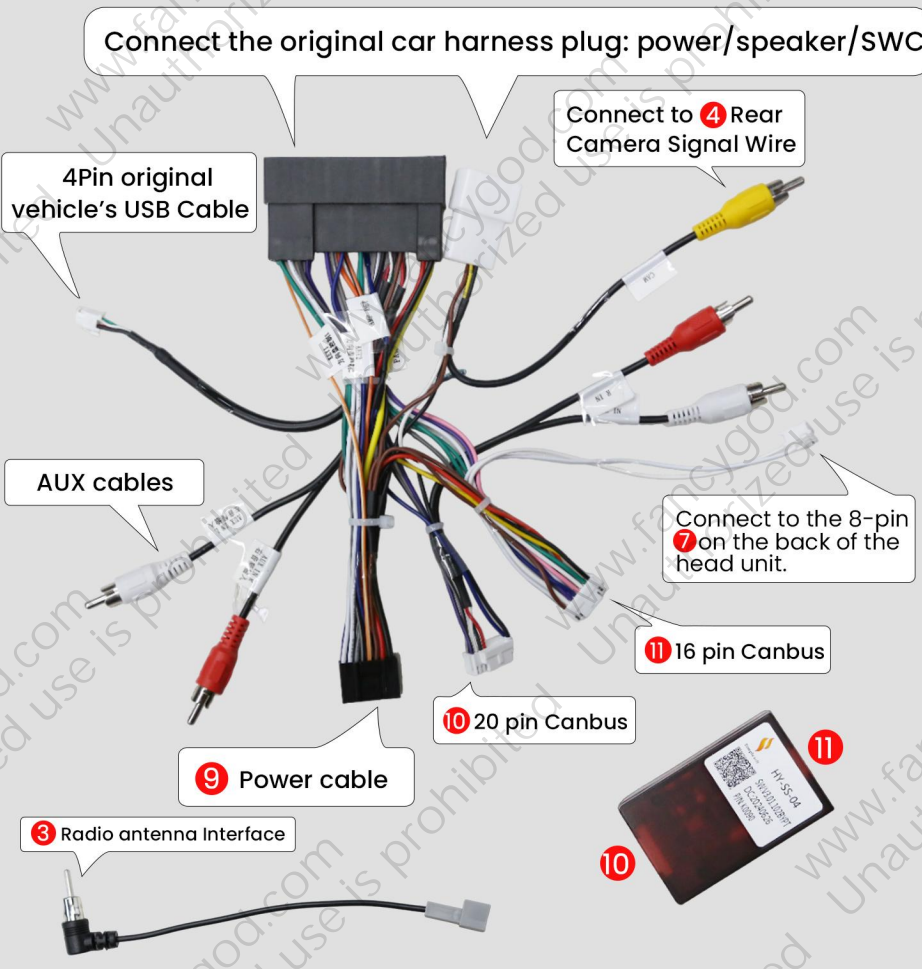

A-cables XC-1398

Connect the original car harness plug: power/speaker/SWC

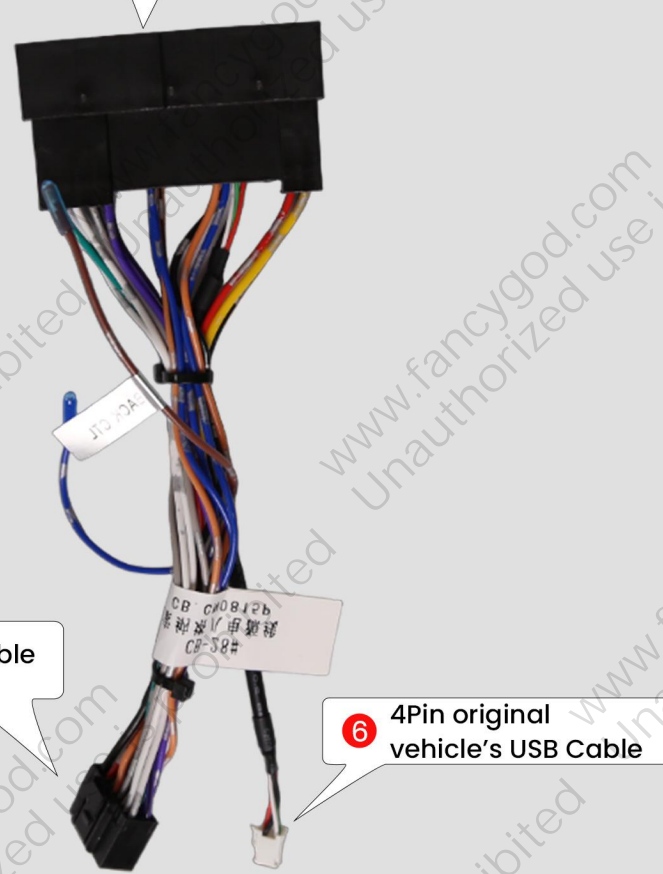

Power Line Definition Chart

Front Left (+)	<input type="checkbox"/>	<input type="checkbox"/>	Rear Right (+)	<input type="checkbox"/>
Front Left (-)	<input type="checkbox"/>	<input type="checkbox"/>	Rear Right (-)	<input type="checkbox"/>
Front Right (+)	<input type="checkbox"/>	<input type="checkbox"/>	Rear Left(+)	<input type="checkbox"/>
Front Right (-)	<input type="checkbox"/>	<input type="checkbox"/>	Rear Left(-)	<input type="checkbox"/>
Steering Wheel Key(+)	<input type="checkbox"/>	<input type="checkbox"/>	Power Antenna(+)	<input type="checkbox"/>
Rear Camera(+)	<input type="checkbox"/>	<input type="checkbox"/>	Steering Wheel Key 2 (+)	<input type="checkbox"/>
Accessory/Ignition(+)	<input checked="" type="checkbox"/>	<input type="checkbox"/>	Dimmer/Illumination (+)	<input type="checkbox"/>
Chassis Ground (-)	<input checked="" type="checkbox"/>	<input checked="" type="checkbox"/>	Constant power supply	<input type="checkbox"/>

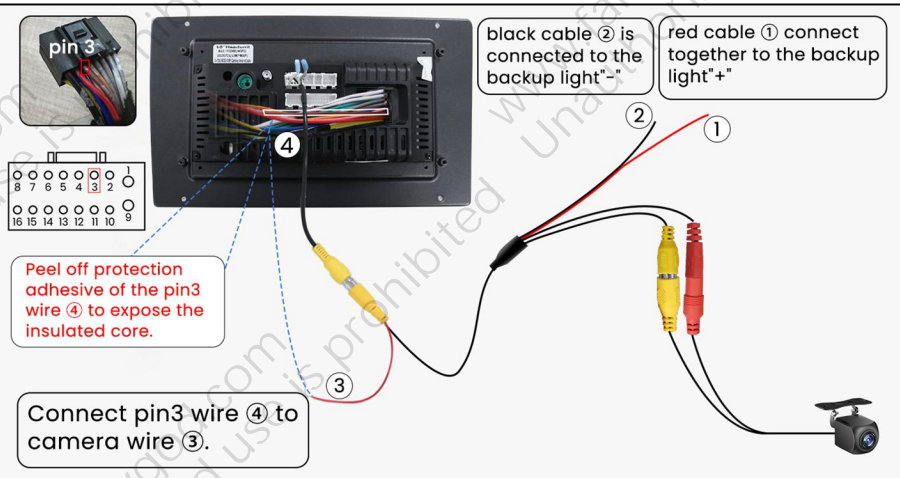

Wires color may be different due to various batches, but pin locations will be the same. You can search Youtube video ID "VWck1CYwF5s" on Youtube to find our supplied camera connection video tutorial

Note: please select the correct wiring harness (A-cables or B-cables) according to the shape and pin configuration of the factory car's plug.

If you are using **A-cables**, please follow the steps shown in picture **1** : Enter Settings → Factory (enter password 3368), then select Car Model and choose “NULL—OTHER—No protocol—Null.”

If your car has steering wheel control buttons, to ensure they work properly, open the SWC app on the radio and follow the app's instructions to manually learn the steering wheel control keys (as shown in picture **2**).



If you are using **B-cables**, to prevent issues with steering wheel controls, air conditioning, or volume not functioning properly, please follow the steps shown in image **3** :

Press Settings → Factory (input password: 3368) → Car Model, and select “XP (Simple) — Hyundai/KIA — Sonata — XP (L) .”

3

CAN Box type	Car Brand	Car Model	CAN Box
★ XP(Simple)	★ Hyundai/KIA	★ Sonata	★ XP(L)
★ OD	★ Volkswagen	★ Sonata9	★ XP(M)
★ LSdT	★ GM/Chevrolet	★ Tucson	★ XP(H)
★ BNR	★ Toyota	★ IX35	
★ DaoJun	★ Nissan	★ Santa	
★ XBS	★ Ford	★ Sorento	

FAQ

Q: How to use wireless Apple CarPlay?

1. Turn on Bluetooth app on the radio and connect to your phone's bluetooth (password: 0000).
2. Open the Carlink 2.0 App on the car radio to activate Carplay. (Scan the QR code on the right to view the video tutorial)

Q: How to use wireless Android auto?

1. Turn on Bluetooth app on the radio and connect to your phone's bluetooth (password: 0000).
2. Download the Android Auto APP at your phone's Play store first (Confirm the phone can support Android Auto).
3. Open the Carlink 2.0 App on the car radio to activate Android Auto. (Scan the QR code on the right to view the video tutorial)