

# USE MANUAL

## Car Stereo

### for Chevy Spark

#### 2013 -2015

Central Control Disassembly  
and Operation

Post-installation rendering



#### Wiring diagram



#### A-cables XC-1246

Connect the original car harness plug: power/speaker/SWC



9 the power socket

#### B-cables XC-1498

Connect the original car harness plug: power/speaker/SWC

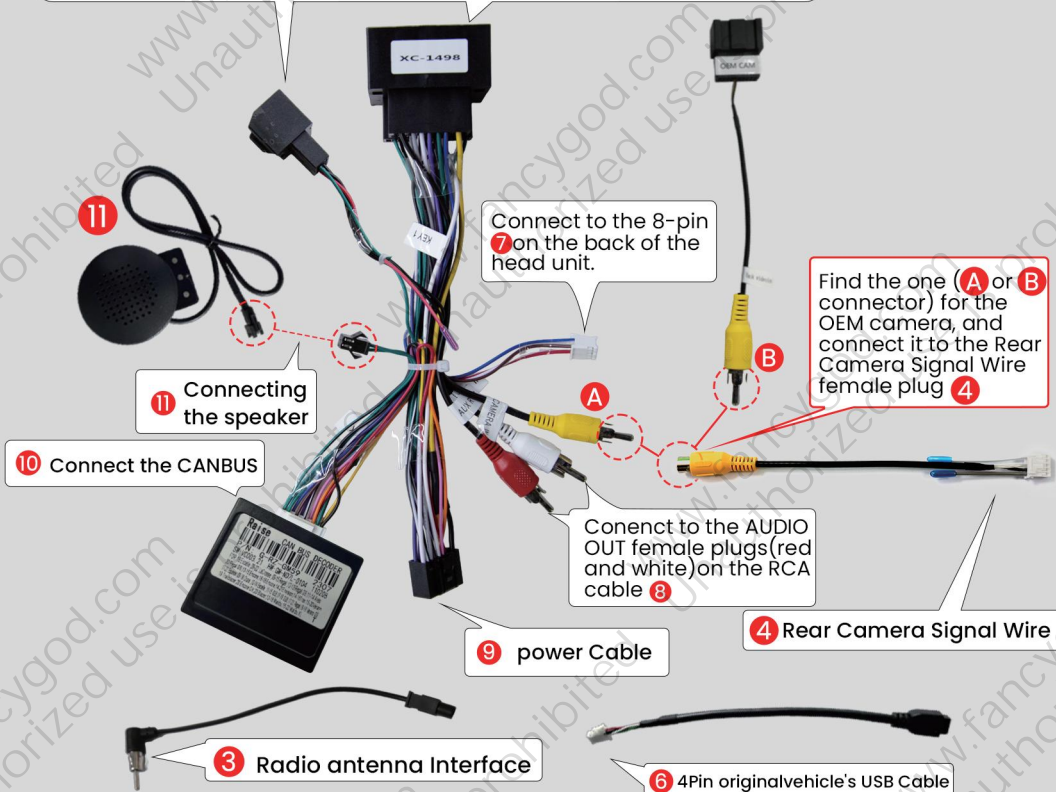

#### Power Line Definition Chart

Front Left (+)	<input type="checkbox"/>	<input type="checkbox"/>	Rear Right (+)
Front Left (-)	<input type="checkbox"/>	<input type="checkbox"/>	Rear Right (-)
Front Right (+)	<input type="checkbox"/>	<input type="checkbox"/>	Rear Left(+)
Front Right (-)	<input type="checkbox"/>	<input type="checkbox"/>	Rear Left(-)
Steering Wheel Key(+)	<input type="checkbox"/>	<input type="checkbox"/>	Power Antenna(+)
Rear Camera(+)	<input type="checkbox"/>	<input type="checkbox"/>	Steering Wheel Key 2 (+)
Accessory/Ignition(+)	<input checked="" type="checkbox"/>	<input type="checkbox"/>	Dimmer/Illumination (+)
Chassis Ground (-)	<input checked="" type="checkbox"/>	<input checked="" type="checkbox"/>	Constant power supply



8 7 6 5 4 3 2 1  
16 15 14 13 12 11 10 9

Peel off protection adhesive of the pin3 wire 4 to expose the insulated core.

Connect pin3 wire 4 to camera wire 3.

black cable 2 is connected to the backup light"-"

red cable 1 connect together to the backup light"+"

Wires color may be different due to various batches, but pin locations will be the same. You can search Youtube video ID "VWCKICYwF5s" on Youtube to find our supplied camera connection video tutorial



**Note: please select the correct wiring harness (A-cables or B-cables) according to the shape and pin configuration of the factory car's plug.**

If you are using **A-cables**, please follow the steps shown in picture **1**: Enter Settings → Factory (enter password 3368), then select Car Model and choose “NULL—OTHER—No protocol—Null.”

If your car has steering wheel control buttons, to ensure they work properly, open the SWC app on the radio and follow the app's instructions to manually learn the steering wheel control keys (as shown in picture **2**).

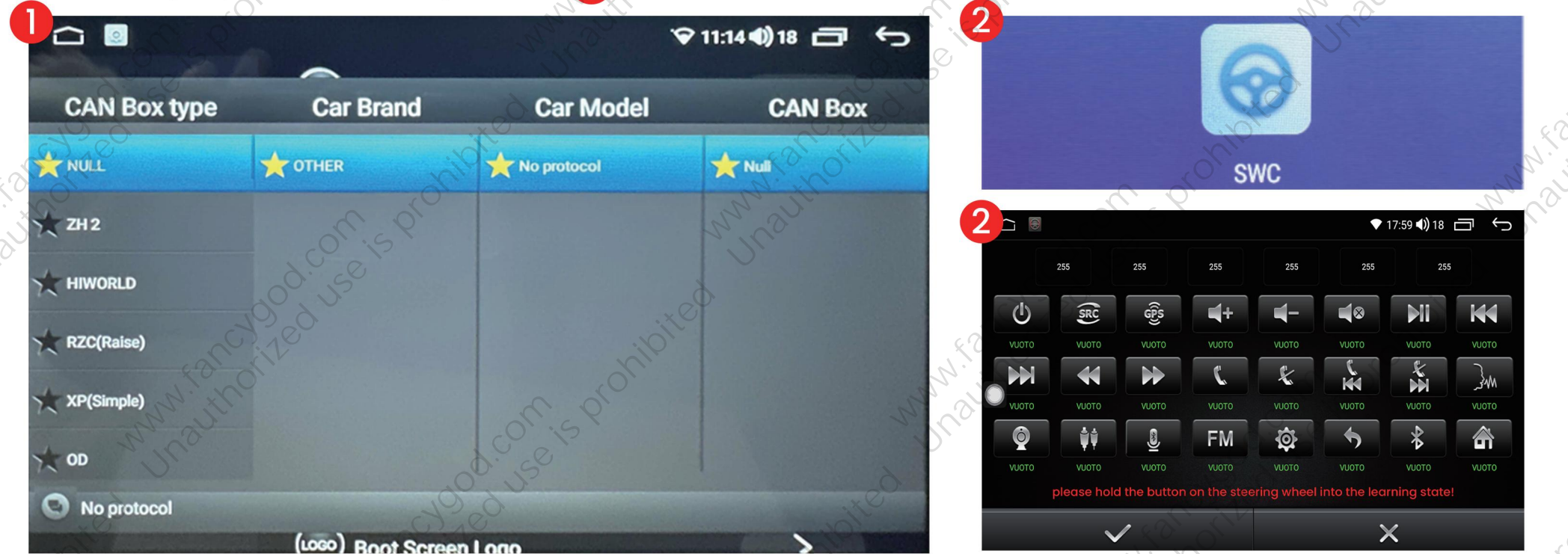

If you are using **B-cables**, to prevent issues with steering wheel controls, air conditioning, or volume not functioning properly, please follow the steps shown in Image **3**:

Press Settings → Factory (input password: 3368) → Car Model, and select “RZC (Raise) — GM/Chevrolet — Cruze — 2009-2017.”



For more guidance/video tutorial, please copy this link or scan the QR code to enter into our official website:

<http://www.fancygod.com>

Instructions

