

USE MANUAL

Car Stereo

for Chevy Silverado 2014-2018

for GMC Sierra 2014-2018

Central Control Disassembly and Operation

Post-installation rendering



Wiring diagram

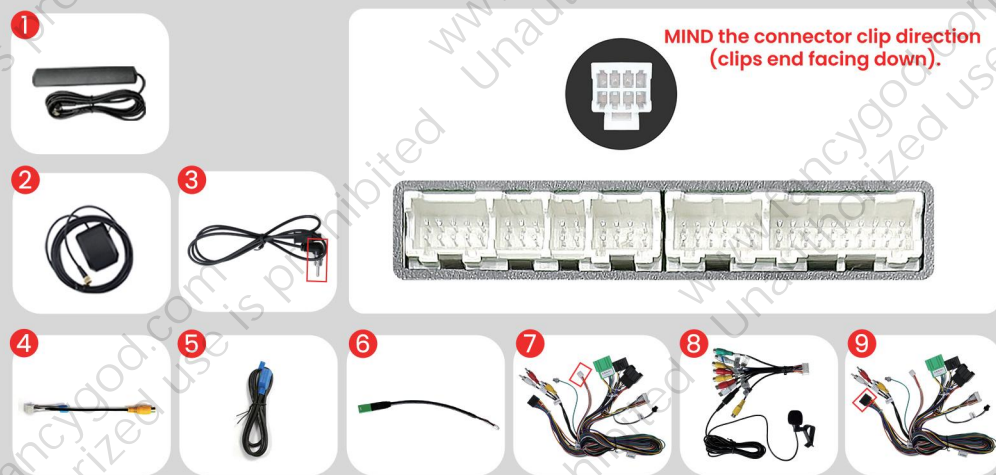
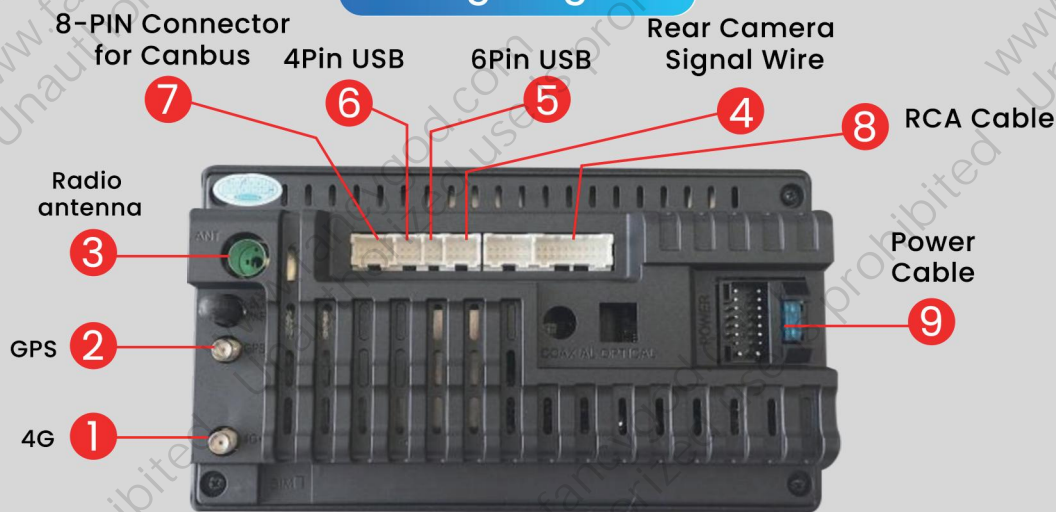

A-cables XC-1255

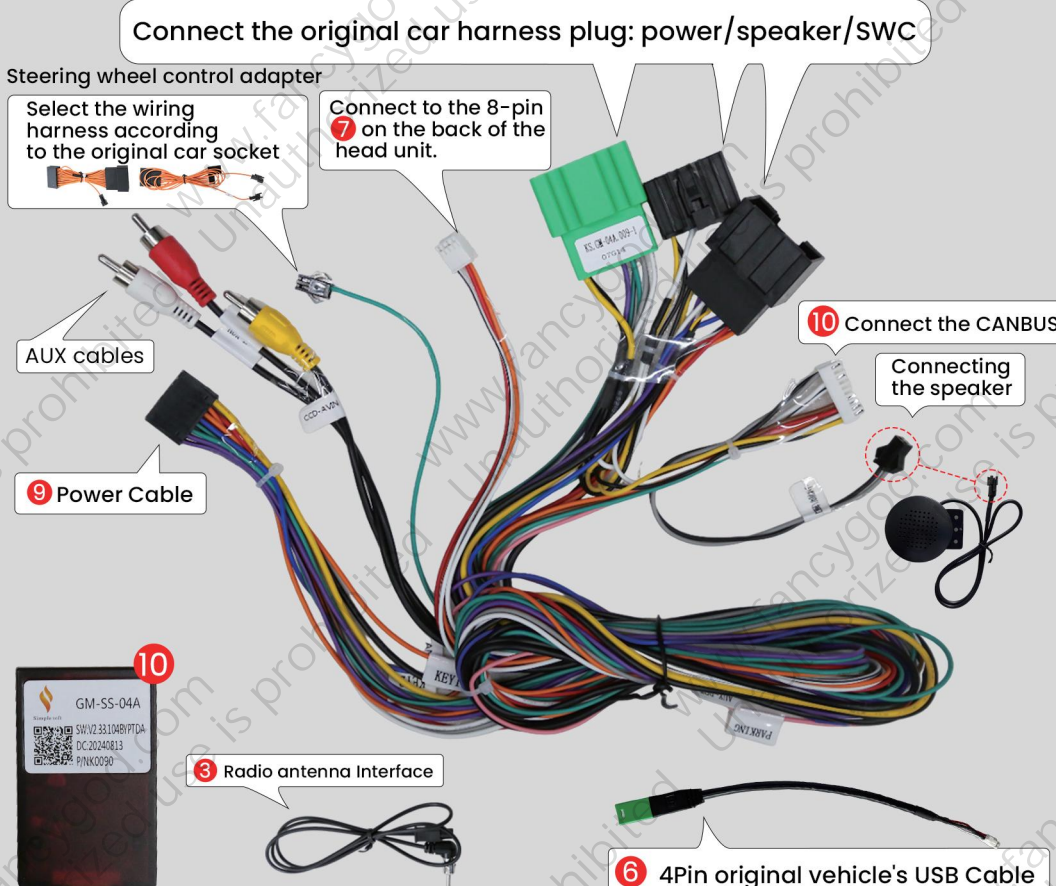

B-cables XC-1256

Connect the original car harness plug: power/speaker/SWC

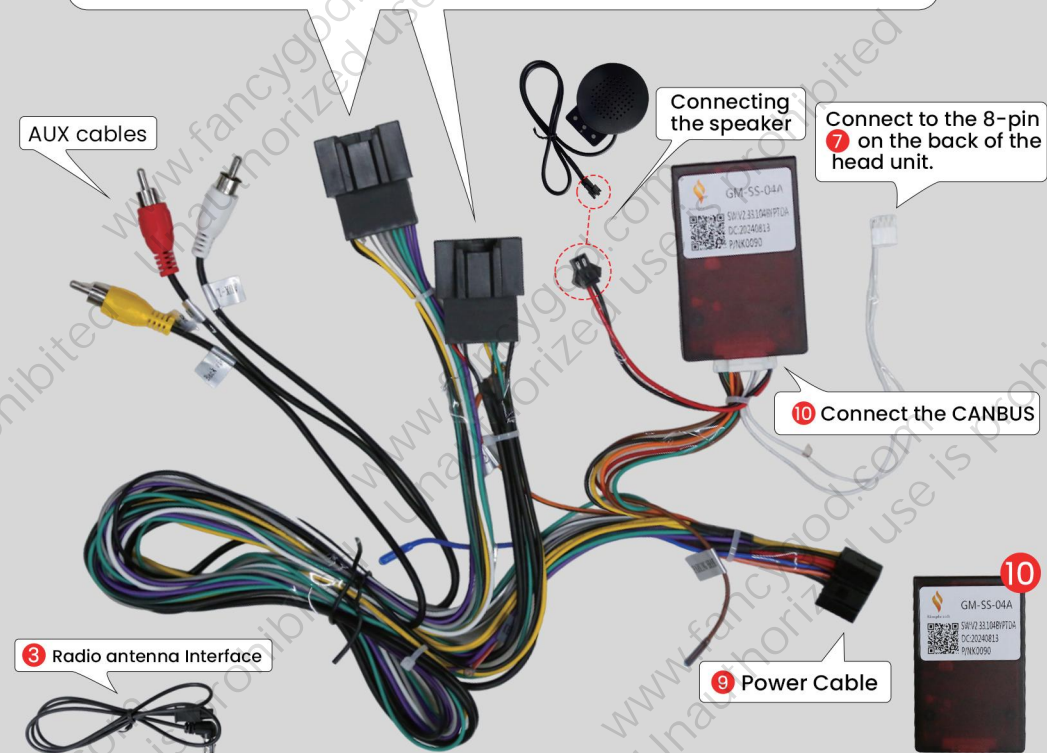

Power Line Definition Chart

Front Left (+)	<input type="checkbox"/>	<input type="checkbox"/>	Rear Right (+)	<input type="checkbox"/>
Front Left (-)	<input type="checkbox"/>	<input type="checkbox"/>	Rear Right (-)	<input type="checkbox"/>
Front Right (+)	<input type="checkbox"/>	<input type="checkbox"/>	Rear Left(+)	<input type="checkbox"/>
Front Right (-)	<input type="checkbox"/>	<input type="checkbox"/>	Rear Left(-)	<input type="checkbox"/>
Steering Wheel Key(+)	<input type="checkbox"/>	<input type="checkbox"/>	Power Antenna(+)	<input type="checkbox"/>
Rear Camera(+)	<input type="checkbox"/>	<input type="checkbox"/>	Steering Wheel Key 2 (+)	<input type="checkbox"/>
Accessory/Ignition(+)	<input type="checkbox"/>	<input type="checkbox"/>	Dimmer/Illumination (+)	<input type="checkbox"/>
Chassis Ground (-)	<input type="checkbox"/>	<input type="checkbox"/>	Constant power supply	<input type="checkbox"/>

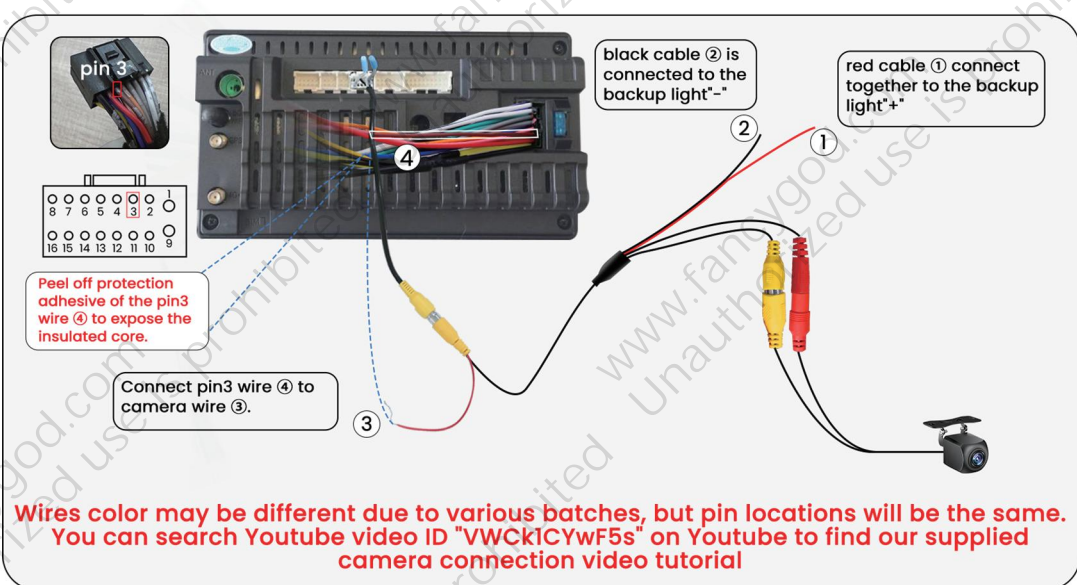

For more guidance/video tutorial, please copy this link or scan the QR code to enter into our official website:

<http://www.fancygod.com>

Instructions



Steering wheel control wiring method



Original Vehicle Steering Control Plug Location



Original Vehicle Steering Control Plug



Remove the original vehicle steering control plug



Two types of steering wheel control adapter cables



One end connects to the factory steering wheel control wire

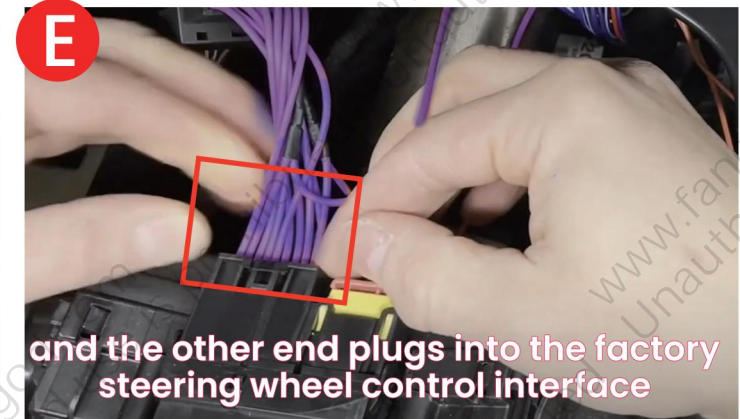

and the other end plugs into the factory steering wheel control interface

Note: please select the correct wiring harness (A-cables or B-cables) according to the shape and pin configuration of the factory car's plug.

To prevent issues with steering wheel controls, air conditioning, or volume not functioning properly, please be sure to follow the steps shown in image 1:

Please press Settings—Factory (input password 3368)—Car Model, and select “XP(Simple)— GM/Chevrolet — ALL — XP(L)”

1

CAN Box type	Car Brand	Car Model	CAN Box
★ XP(Simple)	★ GM/Chevrolet	★ ALL	★ XP(H)
★ OD	★ Toyota	★ LaCrosse	★ XP(L)
★ LSDT	★ Nissan	★ Encore	
★ BNR	★ Ford	★ ExcelleGT	
★ DaoJun	★ Jeep	★ Verano	
★ XBS	★ OPEL	★ Malibu	
⚙ ALL			

FAQ

Q: How to use wireless Apple CarPlay?

1. Turn on Bluetooth app on the radio and connect to your phone's bluetooth (password: 0000).
2. Open the Carlink 2.0 App on the car radio to activate Carplay. (Scan the QR code on the right to view the video tutorial)



Q: How to use wireless Android auto?

1. Turn on Bluetooth app on the radio and connect to your phone's bluetooth (password: 0000).
2. Download the Android Auto APP at your phone's Play store first (Confirm the phone can support Android Auto).
3. Open the Carlink 2.0 App on the car radio to activate Android Auto. (Scan the QR code on the right to view the video tutorial)

