

Post-installation rendering



3.5mm to RCA audio cable

1 Power Cable

13 CVBS-IN-1

4 FR OUT

5 FL OUT

6 RCA Cable

7 20 pin Screen drive box

8 16 pin CANBUS box

9 20 pin CANBUS box

10 steering wheel button adapter cable

11 Connect to the 8-pin on the back of the head unit.

12 CAN BUS DECODER
HIZ 2011 SIL V00015 JUN
For: 09凯迪拉克凯雷德
SN: 2024-0923-1248
Dogen Electronics

13 CAN BUS DECODER
HIZ 07 02 - JPL
SIL 011 Cadillac V27
For: 凯迪拉克凯雷德
415-ATB-115-SRP-CT5
SN: 2024-0923-1223
Dogen Electronics

Front Left (+)			Rear Right (+)
Front Left (-)			Rear Right (-)
Front Right (+)			Rear Left(+)
Front Right			Rear Left(-)
Steering Wheel Key(+)			Power Antenna(+)
Rear Camera(+)			Steering Wheel Key 2 (+)
Accessory/Ignition(+)			Dimmer/Illumination (+)
Chassis Ground (-)			Constant power supply

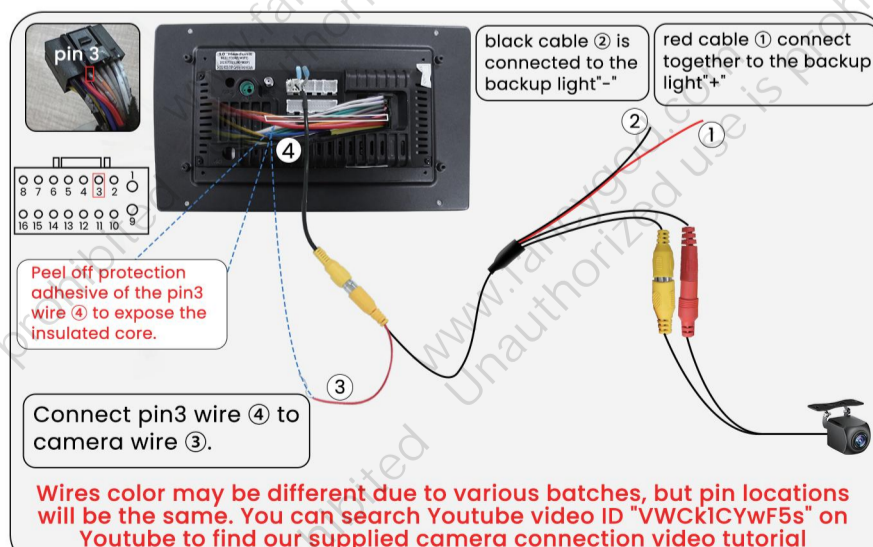

<http://www.fancygod.com>

Instructions



Help:

You can scan the QR code to watch the installation video tutorial online. If you encounter any problem, please contact our customer service team for assistance.



If your car have an AUX port in the armrest compartment, please connect the 3.5mm to RCA audio cable.



If your car does not have an AUX port in the armrest compartment, please contact us, and we will send you an audio adapter as picture show.



If your original car screen is 4 inches, please be sure to follow the setup steps below to prevent issues such as steering wheel controls not functioning.

Please enter Settings—Factory Settings (input password 3368)—Car Model and Choose “DaoJun--Cadillac--ATS--DaoJun”

CAN Box type	Car Brand	Car Model	CAN Box
★ DaoJun	★ Ha/ma	★ ATS	★ DaoJun
★ XBS	★ BYD	★ SRX&XTS	
★ DJ	★ Cadillac	★ SRX	
★ BNR	★ Hyundai/KIA	★ CT5	
★ HC	★ Porsche	★ XT4	
★ BG	★ Dodge		
★ ATS			

If your original car screen is 8 inches, please be sure to follow the setup steps below to prevent issues such as steering wheel controls not functioning.

Please enter Settings—Factory Settings (input password 3368)—Car Model and choose “DaoJun--Cadillac--SRX&XTS--DaoJun”

CAN Box type	Car Brand	Car Model	CAN Box
★ DaoJun	★ Ha/ma	★ ATS	★ DaoJun
★ XBS	★ BYD	★ SRX&XTS	
★ DJ	★ Cadillac	★ SRX	
★ BNR	★ Hyundai/KIA	★ CT5	
★ HC	★ Porsche	★ XT4	
★ BG	★ Dodge		
★ SRX&XTS			