

USE MANUAL

for Hyundai Elantra
2011-2013

Central Control Disassembly
and Operation

Post-installation rendering



Wiring diagram

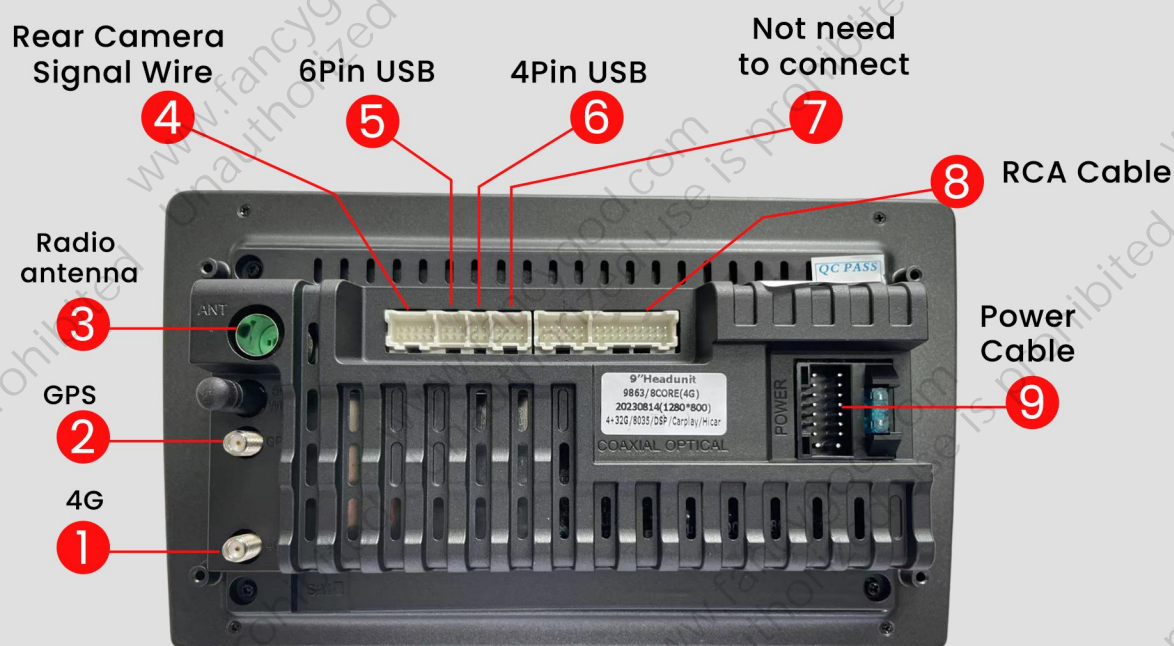

**MIND the connector clip direction
(clips end facing down).**

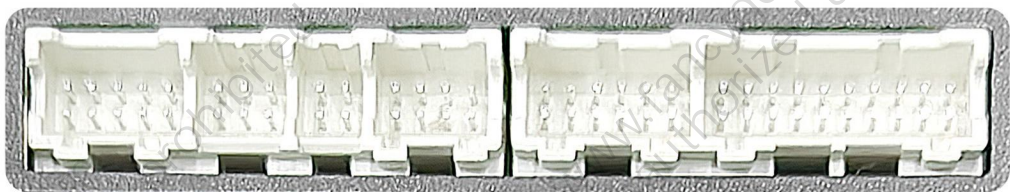

Original Vehicle Wiring Diagram

Connect the original car harness plug: power/speaker/SWC

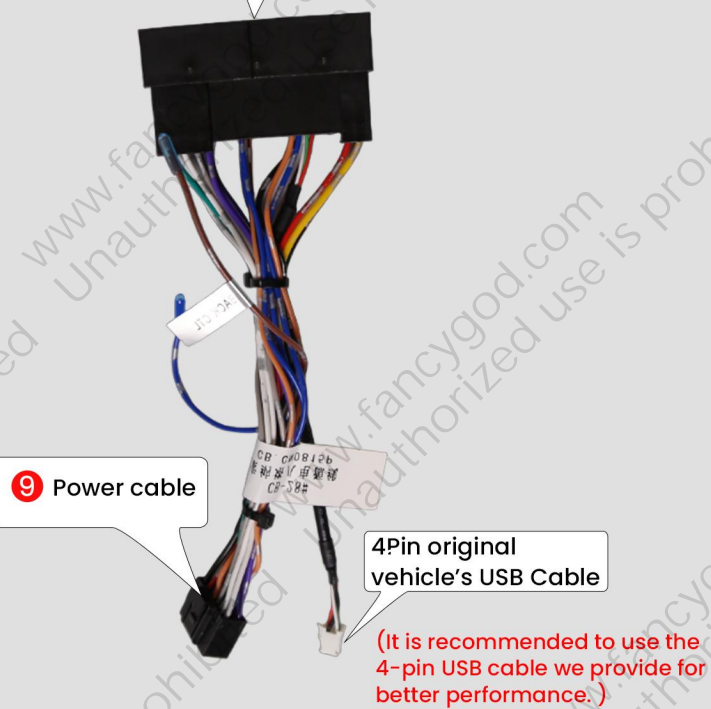

Power Line Definition Chart

Front Left (+)			Rear Right (+)
Front Left (-)			Rear Right (-)
Front Right (+)			Rear Left(+)
Front Right (-)			Rear Left(-)
Steering Wheel Key(+)			Power Antenna(+)
Rear Camera(+)			Steering Wheel Key 2 (+)
Accessory/ignition(+)			Dimmer/Illumination (+)
Chassis Ground (-)			Constant power supply

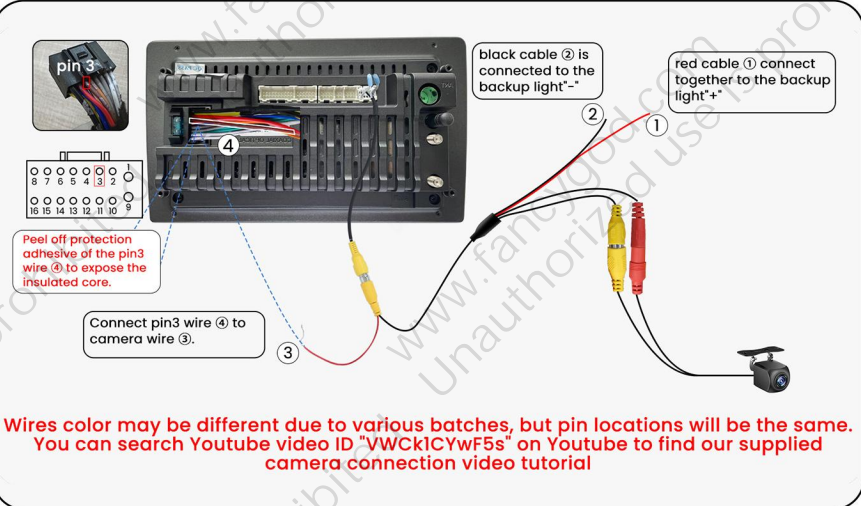

For more guidance/video tutorial, please copy this link or scan the QR code to enter into our official website:

<http://www.fancygod.com>

Instructions



Please be sure to follow the steps shown in pic 1, press Setting→Factory (input password 3368)→Car Model to choose "NULL—OTHER—No protocol—Null".

If your car has steering wheel control buttons, to prevent the steering wheel controls not working properly, please open the SWC app on the radio and refer to the app's instruction to manual learn the steering wheel control keys accordingly (as shown in pic 2).

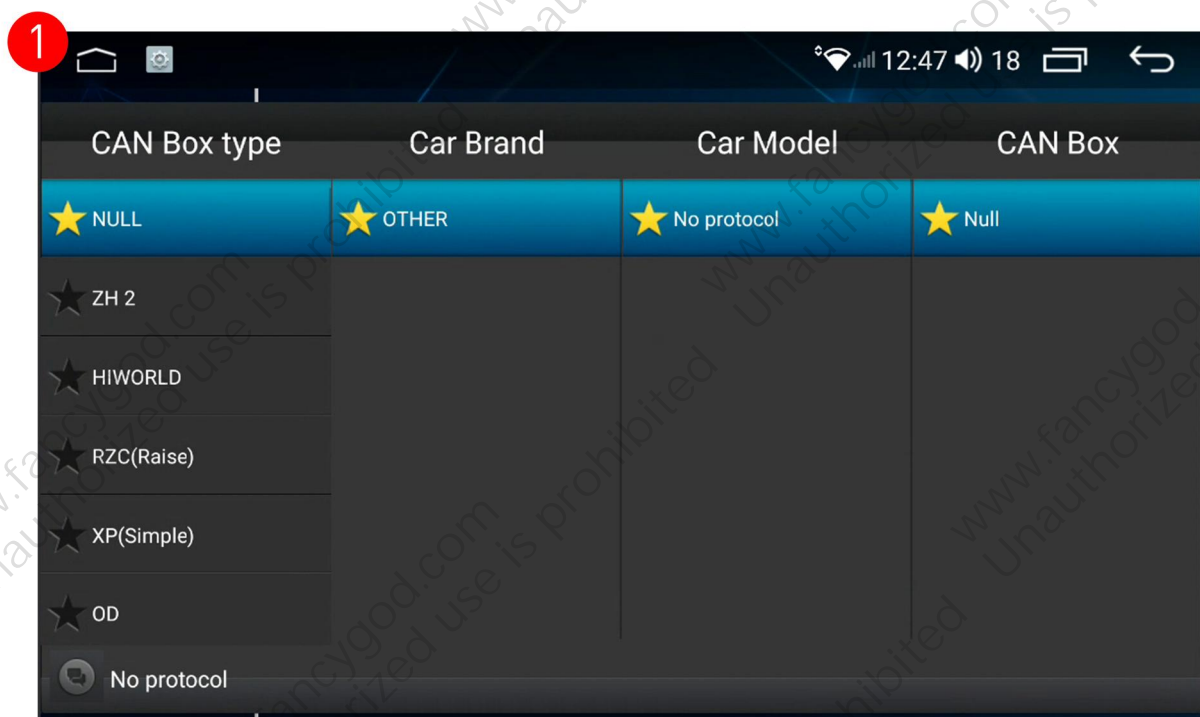

The one with LCD screen is the top configuration. Please contact us to resend the corresponding wiring harness & CANBUS

FAQ

Q: How to use wireless Apple CarPlay?

1. Turn on Bluetooth app on the radio and connect to your phone's bluetooth (password: 0000).
2. Open the Carlink 2.0 App on the car radio to activate Carplay. (Scan the QR code on the right to view the video tutorial)



Q: How to use wireless Android auto?

1. Turn on Bluetooth app on the radio and connect to your phone's bluetooth (password: 0000).
2. Download the Android Auto APP at your phone's Play store first (Confirm the phone can support Android Auto).
3. Open the Carlink 2.0 App on the car radio to activate Android Auto. (Scan the QR code on the right to view the video tutorial)

